



kARtka z synagogą



This **Synagogue Postcard** comprises a simple application of Augmented Reality (AR) based on the synagogue floor plan shown overlaid. To view a 3D model of the Pilica synagogue, download the application »kARtka z synagogą« [Synagogue PostcARd] to your mobile phone and follow the instructions.



<https://arvr.hs-mainz.de/>

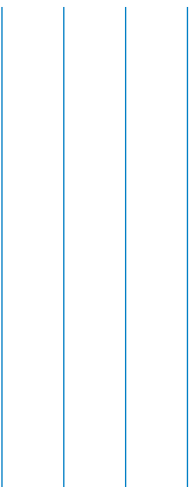

The synagogue in Przeworsk was first built in the 17th Century. After undergoing multiple remodelings, one of which happened in the 1890s, the Synagogue was destroyed on 12.09.1939 by Nazi troops.

The prayer room, measuring approx. 15 x 18 meters, extended across the entire width of the building. The square bima was located in the middle. The extension to the north housed a school for boys. The Synagogue was entered through a western extension with an opulent porch. The women's prayer rooms were located on the upper floors of both extensions.

The main source for this reconstruction was a building survey conducted in 1929 by the IS PAN Institute of Art of the Polish Academy of Sciences. The survey included floor plans, sections and an elevation drawing of the main façade in the south.

The "kARtka z synagogą" research project is an outcome of collaboration between the Institute of Architecture of the Hochschule Mainz – University of Applied Sciences. The project aims to document and promote the lost Jewish heritage. The present 3D reconstruction of the synagogue is based on sources gathered mainly by Maria and Kazimierz Piechotka. The Augmented Reality visualisation of the synagogue is by students Franka Knippschild, Emma Krahé and Albert Schuler.



Partners

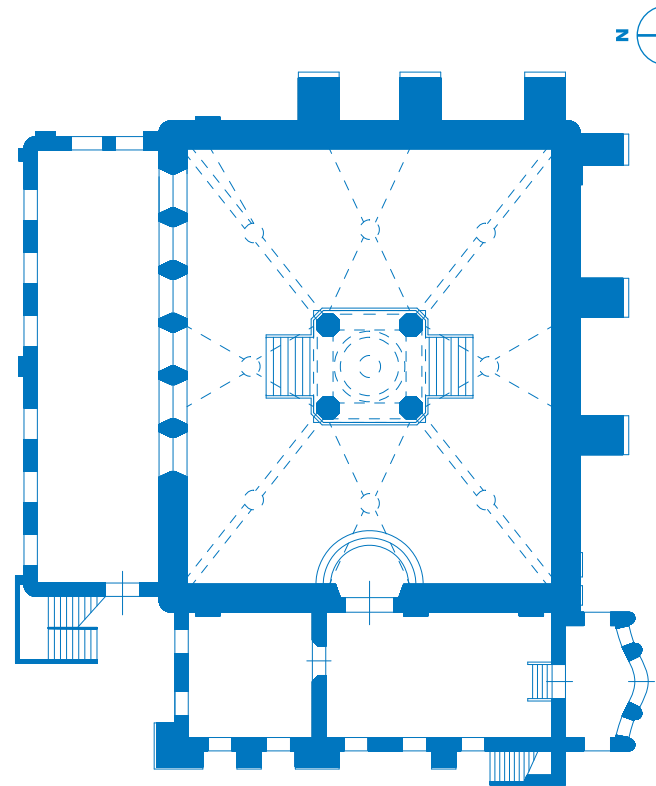

Download the QR code and install the application!

